

Gas Boiler Heating Thermostat User Manual

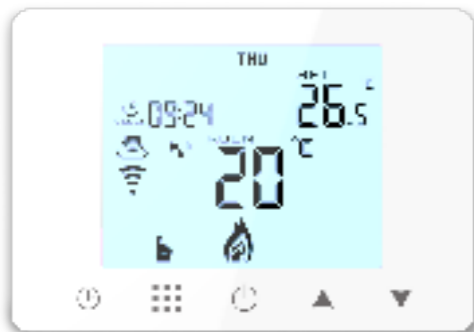

User Manual

Many thanks for your selection of our products and services, and also for your trust and support to us.

Features

- (A) Including built-in sensor and external sensor
- (B) 0.5°C accuracy keeps temperature within the level you set.
- (C) Children lock to prevent misoperation by children
- (D) Data memory when power is off.
- (E) Holiday mode make you enjoy more comfortable temperature in holiday
- (F) The temperature of external sensor can be checked

Product Specifications

Power Supply: 4AAA* 1.5V alkaline batteries
 Range of temperature display: 0~40°C
 Display accuracy: 0.5°C
 Insulating condition: Normal environment
 Probe sensor: NTC(10k)1%
 Running program: Set per 1 week as a cycle
 Contact capacity: 5A
 Output: Switch relay
 Working environment temperature: 0~90°C
 Installation: Wall mounted or on battery seat
 Range of temperature adjustment: 5~35°C
 Size(mm): 130*90*25

1

Displays

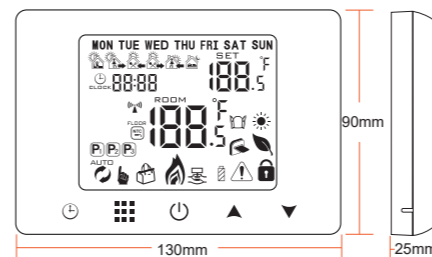

Icon Instruction

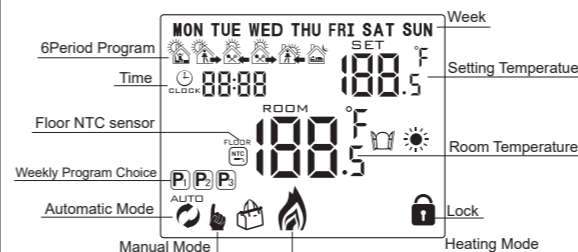

2

Operation Key

| NO | symbols | represent |
|----|---------|--------------------------------------------------------------------------------------------------------------------------------------------------------------------------------------------------------------|
| A | | Turn ON/OFF: Short press to turn on/ turn off |
| B | | 1 Short press to switch programmable mode and manual mode 2 Power on state, long press for 3-5 seconds to do programmable setting 3 Power off state, long press for 3-5 seconds to do advanced setting |
| C | | 1 Confirm key: use it with key 2 Only short press it to set time 3 Turn on thermostat, long press it for 3-5seconds to holiday mode setting |
| D | | 1 Decrease key 2 Long press to lock /unlock |
| E | | 1 Increase key 2 Programmable mode state, press , to enter into temporary manual mode |

3

Operation Instruction

| Mode | Description |
|-----------------------|--------------------------------------------------------------------------------------------------------------------------------------------------------------------------------------------------------------------------------------------------------------------------------------------------------------------------|
| Automatic mode | Short press to switch automatic mode or manual mode On automatic mode, thermostat will operate according to the programmable you have set |
| Manual mode | Short press to switch automatic mode or manual mode On manual mode, you can use or to set temperature, and thermostat will operate according to the temperature you have set |
| Temporary manual mode | On automatic mode ,press , to set temperature, it will access temporary manual mode. When thermostat work to next period, it will return to automatic mode automatically |
| Holiday mode | Power on state, long press to enter into holiday mode setting, press or to change "OFF" to "ON". Then short press to set holiday days, press , to change days. Then short press to set temperature, press , to change temperature. Short press again to confirm. If you want to close holiday mode, short press |

Time Setting

Power on state , short press , the number of minute flashing, press , to change the minute. Then short press , the number of hour flashing, press , to change the hour. Then short press , the letter of week flashing, press , to change the week. Short press again to confirm.

4

Advanced options

Power off state, long press for 3-5 seconds to access advanced setting. From A1 to AC, short press to choose the option, and adjust data by , . After finish setting ,remain about 5 seconds ,it will save setting and exit advanced setting automatically .

| NO | Setting Options | Data Setting Function | Factory Default |
|----|-----------------------------------------------|---------------------------------------------------------------|-------------------------------|
| A1 | Measure Temperature Calibration | -9~+9 C press , to adjust. | Display measuring temperature |
| A2 | Temperature control return difference setting | 1-5 C | 1 C |
| A3 | Children lock setting | 0:half lock 1:full lock | 0 |
| A4 | Limit value of low temperature for | 5-10 C | 5 C |
| A5 | Setting temperature lowest limit | 1-10 C | 5 C |
| A6 | Setting temperature highest Limit | 20-70 C | 35 C |
| A7 | Weekly programming selection | P1: 5+2 P2: 6+1 P3: 7 | P1 |
| A8 | Power on memory function | 0:Power on memory function 1:No power on memory function | 0 |
| A9 | Anti-freeze function | 0: Anti-freeze function close 1: Anti-freeze function open | 0 |
| AA | °C or °F | 0: °C 1: °F | 0 |
| AB | Restore factory defaults | Display A o, long press until show the whole screen | |

5

Sensor fault display: please choose correct working way of built-in and external sensor, if choose wrongly or sensor fault (breakdown), "E1" or "E2" will be displayed on the screen. Thermostat will stop heating until the fault is eliminated.

Programmable Mode Setting

6 times period setting: Power on state, long press enter into first time period (hour setting), press and to adjust value, short press enter into minute setting, press and to adjust value, then short press enter into temperature setting, press and to adjust value, successively short press to set second time period, thirdly time period

| Wake up | Out door | Back home | Out door | Back home | Sleep |
|-----------|-----------|------------|------------|------------|------------|
| | | | | | |
| 6: 00 20C | 8: 00 15C | 11: 30 15C | 13: 30 15C | 17: 00 15C | 22: 00 15C |

Weekly programming setting: under power-off state, long press enter into advanced options, then short press switch to AB option can choose 5+2,6+1,7 modes, default mode is 5+2

Wiring Diagram

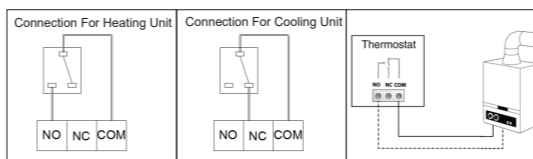

6

Installation diagram:

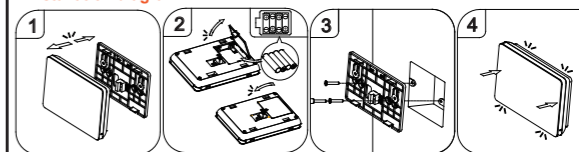

Cautions on Installation and Use

- 1.To prevent the thermostat display from a high fluctuation, special treatment has been made to the program. Therefore, it is normal that the thermostat cannot immediately display the sudden change of temperature.
 - 2.The thermostat installed on 1.5m above the ground.
 - 3.For the thermostat installed, please take care not to install it to the wall corner, door / window side or behind the door or in such unheated area as exterior wall. Avoid hot / cold air duct, radiator, flue or thermal pipe.
 - 4.If you have any problem for the installed ,please contact our company hysen, we will make a demonstration for you
 - 5.Only the professional technicians are permitted to open the transmitter and receiver box of the thermostat for installation. When install the power supply, make sure that the power cable is well insulated.
 - 6.The thermostat is unrepairable product. The user shall not open the internal circuit board.
- Before installing the thermostat, make sure that the system is disconnected. The maximum voltage of the system shall meet the requirements specified in the Instruction Manual (Max. AC Voltage: 240V).

Warranty:

We offer the warranty of 18 months, from the sales day. The products of our company can have lifetime warranty ,if it is not the quality problems, or beyond the warranty period, we will charge for the after-sale service.

7

NO:30518 V1.0